

QUICK START GUIDE

1 Prepare the Reservoir:

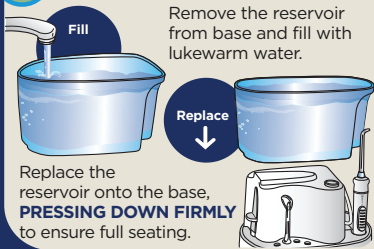

2 Select and Insert Tip:

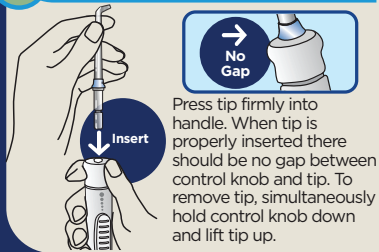

3 Prime Unit (First Time Use Only):

Prior to Very First Use of Unit, Prime Unit:

Set pressure control slide switch on handle to **high**, point the handle and tip into sink. Turn unit **ON** until water flows from the handle, turn unit **OFF**.



4 Adjust Pressure and Pause Control:

For first time users, adjust pressure control to **lowest position**. Gradually increase pressure as you prefer.

You can temporarily stop water flow by pressing the pause button on the handle.

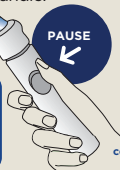
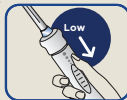

continued on back

5 Using your Waterpik® Water Flosser:

Always place tip in mouth before turning unit on.

Lean over sink and close lips enough to prevent splashing, while still allowing water to flow from mouth into the sink. Turn unit **ON**.

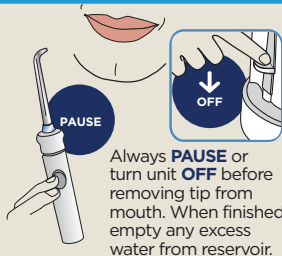
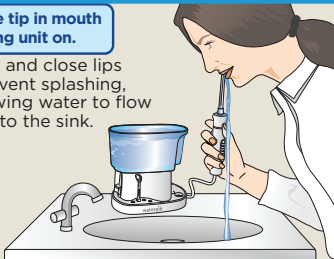

Always **PAUSE** or turn unit **OFF** before removing tip from mouth. When finished empty any excess water from reservoir.

6 Technique Tips for Best Results:

Aim the tip just above the gum line at a 90 degree angle.

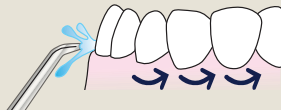

Starting with the back teeth, follow the gumline and pause briefly between teeth.

Continue until all areas around and between teeth have been cleaned.

7 REGISTER YOUR PRODUCT ONLINE NOW!

Receive up to
\$44
in savings.

www.waterpik.com/register

Water Pik, Inc. 1.800.525.2774 • www.waterpik.com

1730 East Prospect Road, Fort Collins, CO 80553-0001 USA

©2009 Water Pik, Inc.

20012884-F AA